

Smart Lock **Universal Lock & Universal Lock II**

# Enhance customer service and increase sales.

Smart Lock is the first electronic lock and key system designed to deliver superior security protection for items merchandised or inventoried inside cabinets. The operational efficiency, improved customer service and speed to check out makes Smart Lock the perfect locked cabinet solution.

- › Sales associates are empowered to access locked display cabinets, delivering a more timely response to customers
- › Enhanced interaction with customers will result in increased sales
- › The IR2 Key and IR2-S Key eliminate the need to search for a manager with the “master” mechanical key set

### Universal Lock Specs

- › Designed for glass bypass doors
  - Universal Lock: For panel gap 8 mm – 11 mm (0.3” – 0.5”)
  - Universal Lock II: For panel gap 4.5 mm – 8 mm (0.2” – 0.3”)
- › Easy to install, use and maintain – no drilling or tools required
- › No re-keying of locks when keys are lost, broken or stolen
- › E Ink® display provides visual confirmation that lock is locked or unlocked



Lock Status Indicator



Universal Lock



Universal Lock II

**PL106**

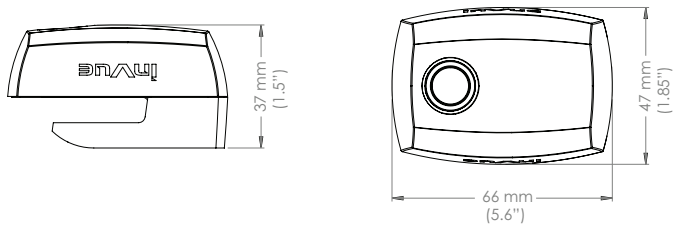

**PL120-3**

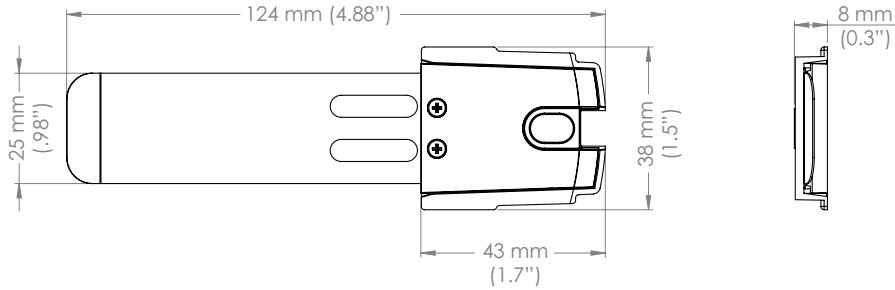

**PL103**

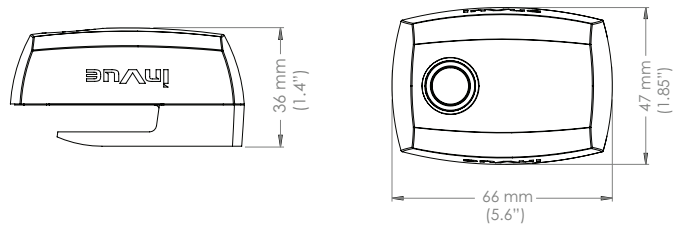

**PL123-3**

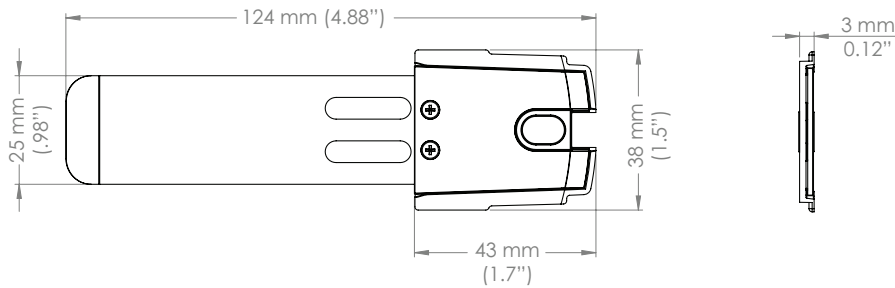

InVue's Smart Lock utilizes the new InVue IR2 Key. The IR2 Key provides a unique store code and time out feature for added security. And the IR2 Key will also work with all InVue PODs.





**PL106 – UNIVERSAL LOCK**

ORDER CODE	DESCRIPTION	ORDER QTY.	CARTON QTY.
PL106-B PL106-W	Universal Lock (For 6mm panels) – black Universal Lock (For 6mm panels) – white	1	25
PL120-1	Strike Plate – Extra Narrow Overlap	1	25
PL120-2	Strike Plate – Narrow Overlap	1	25
PL120-3	Strike Plate – Standard Overlap	1	25
PL120-4	Strike Plate – Wide Overlap	1	25
PL120-5	Strike Plate – Extra Wide Overlap	1	25
PL143	Shim – For PL120 Strike Plate (5 pack)	1	25
PL156	Sizing Tool – For Universal Lock	1	25

**PL103 – UNIVERSAL LOCK II**

ORDER CODE	DESCRIPTION	ORDER QTY.	CARTON QTY.
PL103-B PL103-W	Universal Lock II (For 4.8mm panels) – black Universal Lock II (For 4.8mm panels) – white	1	25
PL123-1	Strike Plate – Extra Narrow Overlap	1	25
PL123-2	Strike Plate – Narrow Overlap	1	25
PL123-3	Strike Plate – Standard Overlap	1	25
PL123-4	Strike Plate – Wide Overlap	1	25
PL123-5	Strike Plate – Extra Wide Overlap	1	25
PL144	Shim – For PL103 Strike Plate (5 pack)	1	25
PL145	ShimShim – For PL123 Strike Plate (5 pack)	1	25
PL153	Sizing Tool – For Universal Lock II	1	25



**UNIVERSAL LOCK & UNIVERSAL LOCK II**

ORDER CODE	DESCRIPTION	ORDER QTY.	CARTON QTY.
PL141	Universal Lock Adhesive (5 pack)	1	25
PL142	Universal Lock Panel Handle (5 pack)	1	25
PL151	Removal Tool	1	25

**CORPORATE OFFICE** // North America// 704.752.6513// 888.55.INVUE

**EUROPEAN OFFICE** // The Netherlands // +31.23.8900150

**ASIAN OFFICE** // Hong Kong // +852.3127.6811

**LATIN AMERICA OFFICE** // Mexico // +52.55.90003957

©2013 InVue Security Products. No endorsement of InVue products has been made by any of the manufacturers of the products shown. Product is sold pursuant to InVue's warranty which can be found at [www.invuesecurity.com/english/warranty.html](http://www.invuesecurity.com/english/warranty.html)

